

# STAR PRIDE, STAR BREEZE, STAR LEGEND TRANSFORMED BY THE \$250 MILLION STAR PLUS INITIATIVE

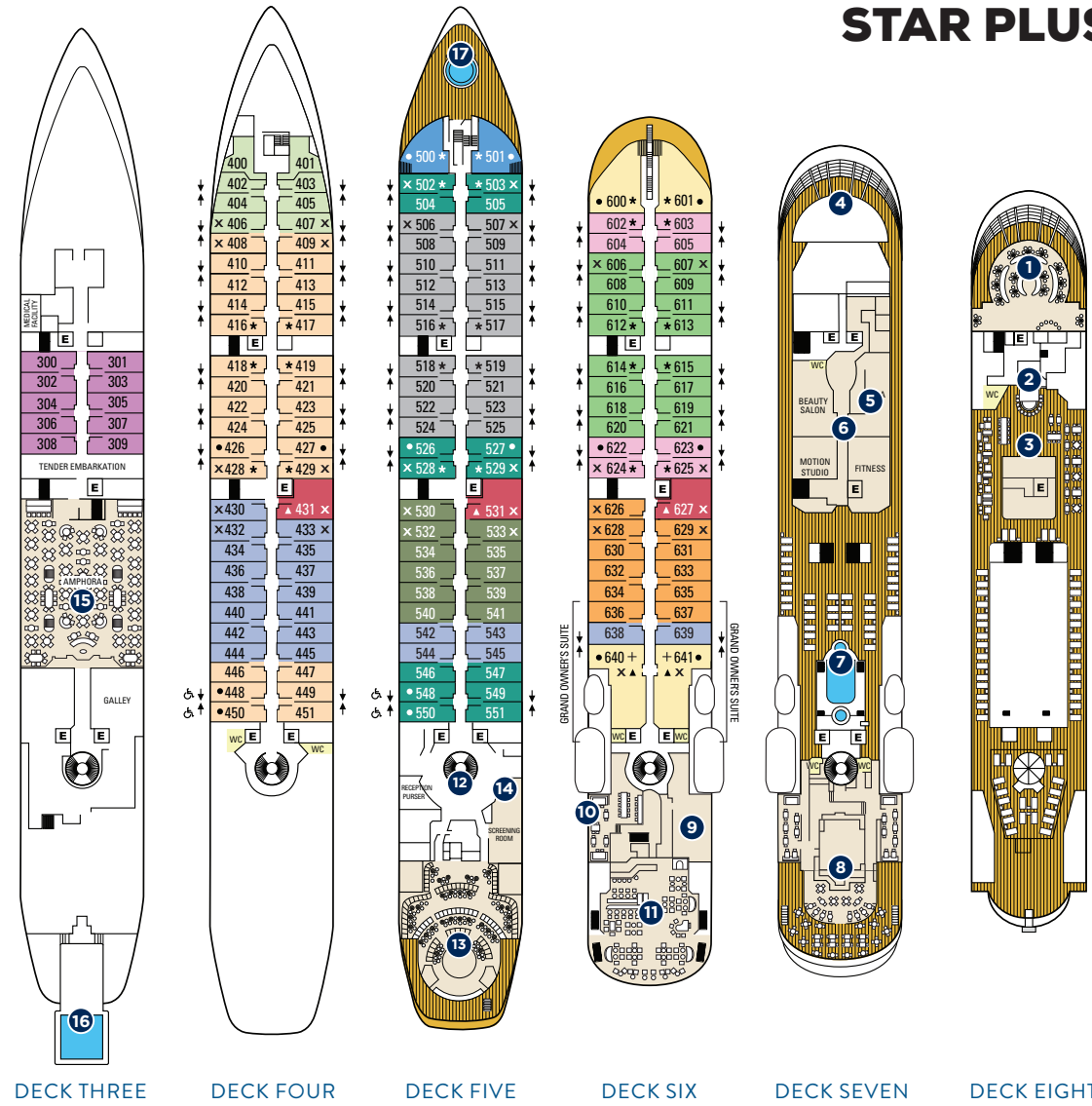

**STAR BREEZE**  
voyages starting  
February 20, 2020

**STAR LEGEND**  
voyages starting  
July 2, 2020

**STAR PRIDE**  
voyages starting  
November 20, 2020

- + RESTRICTED VIEW
  - ↑ ADJOINING SUITES
  - E ELEVATOR
  - \* INCLUDES BATHTUB
  - ▲ SEPARATE BATHTUB & SHOWER
  - ONE QUEEN SIZE BED ONLY (no twin option)
  - x 3<sup>RD</sup> BERTH AVAILABLE
  - ◊ MODIFIED ACCESSIBLE SUITES
- Feature a full-size bed (no twin option)  
Suites 448, 450, 548, & 550 are modified accessible, shower only with a small lip into shower, only one sink, a step into the bathroom with a portable ramp, standard interior and exterior doorways.



GRAND OWNER'S SUITE



OWNER'S SUITE, MIDSHIP

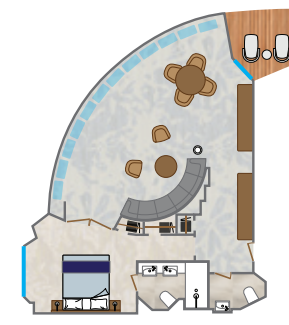

OWNER'S SUITE, FORWARD\*

## ALL-SUITE SHIPS

**Grand Owner's Suites:**  
3 Bedroom Suites, 640/638/636 or 641/639/637: 1,374 square feet (128 square meters)  
Can also be booked as 2 Bedroom Suites, 640/638 or 641/639: 1,097 square feet (102 square meters)  
**Owner's Suites Midship, 640 and 641 (OW):** 820 square feet (76 square meters), both with 3<sup>rd</sup> berths

**Owner's Suites Forward, 600 and 601 (OW):** 575 square feet (54 square meters)  
**Classic Suites, 500 and 501 (CS):** 400 square feet (37 square meters)  
**Deluxe Suites, 431, 531, 627 (DS):** 406 square feet (37 square meters), all with 3<sup>rd</sup> berths. Cabin 431 has two picture windows, excludes balcony



CLASSIC SUITE



DELUXE SUITE



STAR BALCONY SUITE

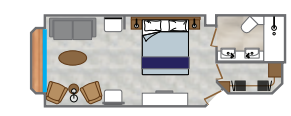

BALCONY SUITE



STAR OCEAN VIEW SUITE

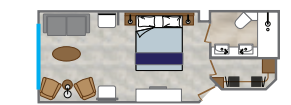

OCEAN VIEW SUITE



STAR PORTHOLE SUITE

**Star Balcony Suites (SBS, SBS1):** 277 square feet (26 square meters)  
**Star Balcony Suites with 3<sup>rd</sup> berths – 530, 532, 533, 626, 628, 629**

**Star Ocean View Suites (SS1):** 277 square feet (26 square meters)  
**Star Ocean View Suites with 3<sup>rd</sup> berths – 430, 432, 433**

**Balcony Suites (BS, BS1):** 277 square feet (26 square meters)

**Ocean View Suites (S, S1, S2, S3):** 277 square feet (26 square meters)

**Balcony Suites with 3<sup>rd</sup> berths – 506, 507, 606, 607**

**Ocean View Suites with 3<sup>rd</sup> berths – 406, 407, 408, 409, 428, 429, 502, 503, 528, 529, 624, 625**

**Star Porthole Suites (SP):** 277 square feet (26 square meters)

## ONBOARD SPACES

- |                                  |                               |                         |
|----------------------------------|-------------------------------|-------------------------|
| 1 Yacht Club Café & Library      | 7 Pool and whirlpool          | 14 Screening Room       |
| 2 Star Bar                       | 8 Veranda/Candles             | 15 Amphora Restaurant   |
| 3 Star Grill by Steven Raichlen  | 9 Signature Shop              | 16 Watersports Platform |
| 4 Bridge                         | 10 Cuadro 44 by Anthony Sasso | 17 Whirlpool            |
| 5 WindSpa                        | 11 Compass Rose               | E Elevator              |
| 6 Fitness Center & Motion Studio | 12 Reception                  | WC Public Restroom      |
|                                  | 13 Lounge                     |                         |

- Owner's Suite (OW)
- Classic Suite (CS)
- Deluxe Suite (DS)
- Star Balcony Suite (SBS1)
- Balcony Suite (BS1)
- Star Balcony Suite (SBS)
- Balcony Suite (BS)
- Ocean View Suite (S3)
- Ocean View Suite (S2)
- Star Ocean View Suite (SS1)
- Ocean View Suite (S1)
- Ocean View Suite (S)
- Star Porthole Suite (SP)

## SHIP FACTS

**GUEST CAPACITY:** 312  
**GUEST DECKS:** 6  
**CREW MEMBERS:** 188-190  
**LENGTH:** 522 feet (159 meters)  
**BEAM:** 62 feet (19 meters)  
**DRAFT:** 17.7 feet (5.4 meters)  
**CRUISING SPEED:** 15 knots

**PROPULSION:** Twin propeller, driven by two Wartsila diesel engines  
**TONNAGE:** 12,995 gross registered tons (grt)  
**SHIP'S REGISTRY:** Bahamas



• Access to board ship is via stairs only.  
• Access to/from outside deck may require assistance with doors and thresholds.